

Sheaves

2AKH STYLE

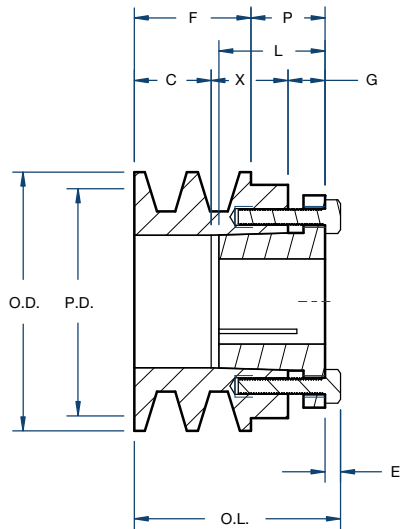

BLACKSTAR®



Type 1

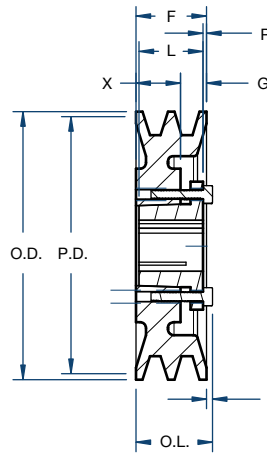

Type 2

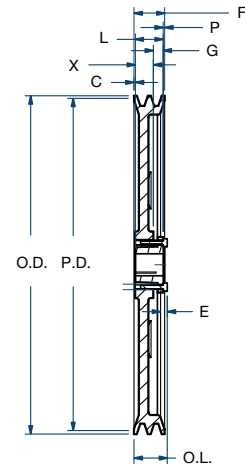

Type 3

Part No.	Diameter (in)			Type	Dimensions (in)								Approx. Weight (lbs)
	Outside	Pitch 4L/A	Pitch 5L/B		O.L.	F	L	P	C	X	G	E	
2AK30H	3.05	2.80	2.46	1	2-7/16	1-3/8	1-1/4	7/8	15/16	7/8	7/16	3/16	1.4
2AK32H	3.25	3.00	2.66	1	2-7/16	1-3/8	1-1/4	7/8	15/16	7/8	7/16	3/16	1.7
2AK34H	3.45	3.20	2.86	1	2	1-3/8	1-1/4	7/16	1/2	7/8	7/16	3/16	1.8
2AK39H	3.75	3.50	3.16	1	2	1-3/8	1-1/4	7/16	1/2	7/8	7/16	3/16	1.8
2AK41H	3.95	3.70	3.36	2	1-1/2	1-3/8	1-1/4	1/16	—	7/8	7/16	3/16	1.9
2AK44H	4.25	4.00	3.66	2	1-1/2	1-3/8	1-1/4	1/16	—	7/8	7/16	3/16	2.4
2AK46H	4.45	4.20	3.86	2	1-1/2	1-3/8	1-1/4	1/16	—	7/8	7/16	3/16	2.5
2AK49H	4.75	4.50	4.16	2	1-1/2	1-3/8	1-1/4	1/16	—	7/8	7/16	3/16	3.1
2AK51H	4.95	4.70	4.36	2	1-1/2	1-3/8	1-1/4	1/16	—	7/8	7/16	3/16	3.2
2AK54H	5.25	5.00	4.66	2	1-1/2	1-3/8	1-1/4	1/16	—	7/8	7/16	3/16	3.4
2AK56H	5.45	5.20	4.86	2	1-1/2	1-3/8	1-1/4	1/16	—	7/8	7/16	3/16	3.6
2AK59H	5.75	5.50	5.16	3	1-1/2	1-3/8	1-1/4	1/16	0	7/8	7/16	3/16	3.4
2AK61H	5.95	5.70	5.36	3	1-1/2	1-3/8	1-1/4	1/16	0	7/8	7/16	3/16	3.3
2AK64H	6.25	6.00	5.66	3	1-1/2	1-3/8	1-1/4	1/16	0	7/8	7/16	3/16	3.9
2AK74H	7.25	7.00	6.66	3	1-1/2	1-3/8	1-1/4	1/16	0	7/8	7/16	3/16	4.9
2AK84H	8.25	8.00	7.66	3	1-1/2	1-3/8	1-1/4	1/16	0	7/8	7/16	3/16	5.8
2AK94H	9.25	9.00	8.66	3	1-1/2	1-3/8	1-1/4	1/16	0	7/8	7/16	3/16	6.1
2AK104H	10.25	10.00	9.66	3	1-1/2	1-3/8	1-1/4	1/16	0	7/8	7/16	3/16	7.7
2AK114H	11.25	11.00	10.66	3	1-1/2	1-3/8	1-1/4	1/16	0	7/8	7/16	3/16	8.5
2AK124H	12.25	12.00	11.66	3	1-1/2	1-3/8	1-1/4	1/16	0	7/8	7/16	3/16	9.5
2AK134H	13.25	13.00	12.66	3	1-1/2	1-3/8	1-1/4	1/16	0	7/8	7/16	3/16	11.4
2AK144H	14.25	14.00	13.66	3	1-1/2	1-3/8	1-1/4	1/16	0	7/8	7/16	3/16	11.9
2AK154H	15.25	15.00	14.66	3	1-1/2	1-3/8	1-1/4	1/16	0	7/8	7/16	3/16	13.3
2AK184H	18.25	18.00	17.66	3	1-1/2	1-3/8	1-1/4	1/16	0	7/8	7/16	3/16	16.8